

NIEMEYER 1985 *design Oscar Niemeyer*

Product: RECTANGULAR DESK

In 1985 Estel commissioned Oscar Niemeyer to create a conference table. What he imagined fully interpreted the dual vocation of the Italian design company, knowing how to smoothly move between home and office. The table, designed both for home interiors and for office executive spaces, is characterized by an important base: one single sculptural leg made in wood covered with brushed steel, with internal counterweight plates. The top can be either in transparent glass or in a vast choice of solid woods. Presented also in the double version, it can reach a length of 4.5 meters.

A Niemeyer's unmistakable signature, with its metal base in relief projecting a plastic form: this table designed for Estel, is one of the few pieces the Brazilian architect dedicated to interior design.

TECHNICAL FEATURES

Top

The top is made of 20 mm to 40 mm thick solid wood rounded off on the corners or made of 19 mm thick tempered float glass.

Base

Base made of coated marine plywood; there are counterweight plates inside

Electrification

Cables passage on the base.

MAINTENANCE

For cleaning use a soft cloth, possibly a microfiber cloth and neutral soap diluted in water.

It is absolutely forbidden to use abrasive powders, acetone, trichloroethylene, ammonia and all agents containing these.



FINISHES

Solid Cat. A: Maple, Barrique oak

Solid Cat. B: Hickory, Wengé, Zebrano

Base metal: satin stainless steel, natural copper, matt brass

Rectangular solid desk, satin stainless steel base

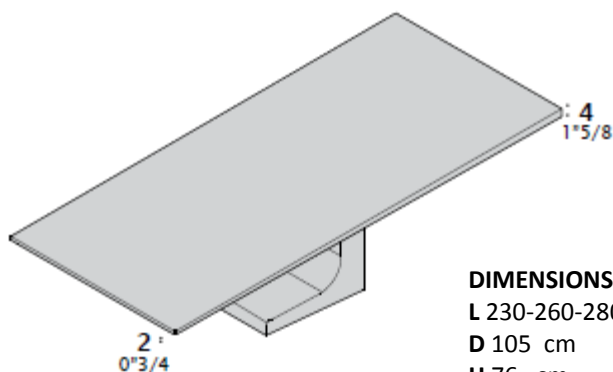

DIMENSIONS
L 230-260-280 cm
D 105 cm
H 76 cm

Rectangular glass desk, satin stainless steel base

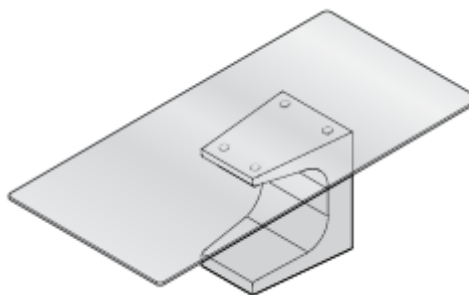

DIMENSIONS
L 230-260 cm
D 105 cm
H 76 cm

CERTIFICATIONS

The product complies with all the safety requirements and reached the highest level of performance certificates

NIEMEYER 1985 *design Oscar Niemeyer*

Product: SQUARE TABLE

In 1985 Estel commissioned Oscar Niemeyer to create a conference table. What he imagined fully interpreted the dual vocation of the Italian design company, knowing how to smoothly move between home and office. The table, designed both for home interiors and for office executive spaces, is characterized by an important base: one single sculptural leg made in wood covered with brushed steel, with internal counterweight plates. The top can be either in transparent glass or in a vast choice of solid woods. Presented also in the double version, it can reach a length of 4.5 meters.

A Niemeyer's unmistakable signature, with its metal base in relief projecting a plastic form: this table designed for Estel, is one of the few pieces the Brazilian architect dedicated to interior design.

TECHNICAL FEATURES

Top

The top is made of 20 mm thick solid wood rounded off on the corners or made of 19 mm thick tempered float glass.

Base

Base made of coated marine multilayer; there are counterweight plates inside.

Electrification

Cables passage on the base.

MAINTENANCE

For cleaning use a soft cloth, possibly a microfiber cloth and neutral soap diluted in water.

It is absolutely forbidden to use abrasive powders, acetone, trichloroethylene, ammonia and all agents containing these.



FINISHES

Solid Cat. A: Maple, Barrique oak

Solid Cat. B: Hickory, Wengé, Zebrano

Base metal: satin stainless steel, natural copper, matt brass

Solid wood square table, satin stainless steel base

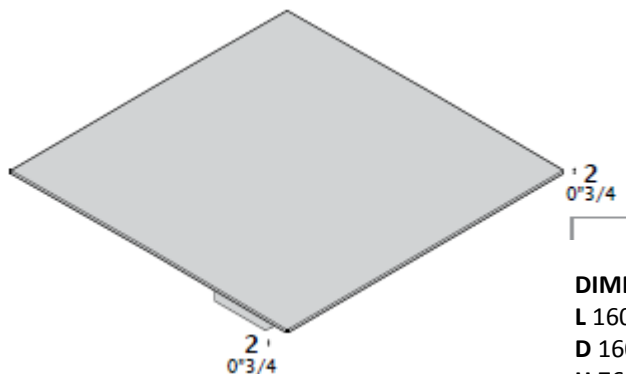

DIMENSIONS

L 160-200 cm
D 160-200 cm
H 76 cm

Glass square table, satin stainless steel base

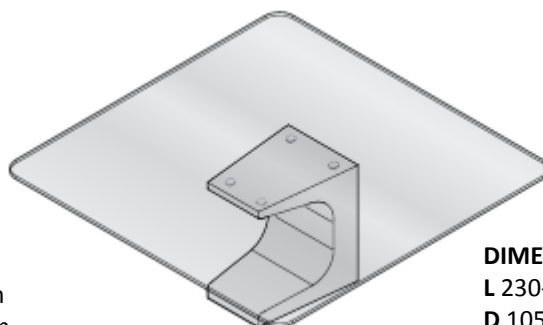

DIMENSIONS

L 230-260 cm
D 105 cm
H 76 cm

NIEMEYER 1985 *design Oscar Niemeyer*

Product: GLASS OR LEATHER RECTANGULAR TABLE WITH TOP ACCESS AND CABLE TRAYS\ AND SOCKET BOXES

In 1985 Estel commissioned Oscar Niemeyer to create a conference table. What he imagined fully interpreted the dual vocation of the Italian design company, knowing how to smoothly move between home and office. The table, designed both for home interiors and for office executive spaces, is characterized by an important base: one single sculptural leg made in wood covered with brushed steel, with internal counter-weight plates. The top can be either in transparent glass or in a vast choice of solid woods. Presented also in the double version, it can reach a length of 4.5 meters.

A Niemeyer's unmistakable signature, with its metal base in relief projecting a plastic form: this table designed for Estel, is one of the few pieces the Brazilian architect dedicated to interior design.

TECHNICAL FEATURES

Top

The top is made of 19 mm thick tempered float glass and of 50 mm thick MDF panels, tapered towards the edge, 18 mm thick coated with soft leather

Base

The base is made of coated marine plywood; there are counter weight plates inside.

Electrification

Cable passage on the base and top access.

MAINTENANCE

For cleaning use a soft cloth, possibly a microfiber cloth and neutral soap diluted in water.

It is absolutely forbidden to use abrasive powders, acetone, trichloroethylene, ammonia and all agents containing these.

DIMENSIONS

L 300-400-500 cm

D 150 cm

H 76 cm

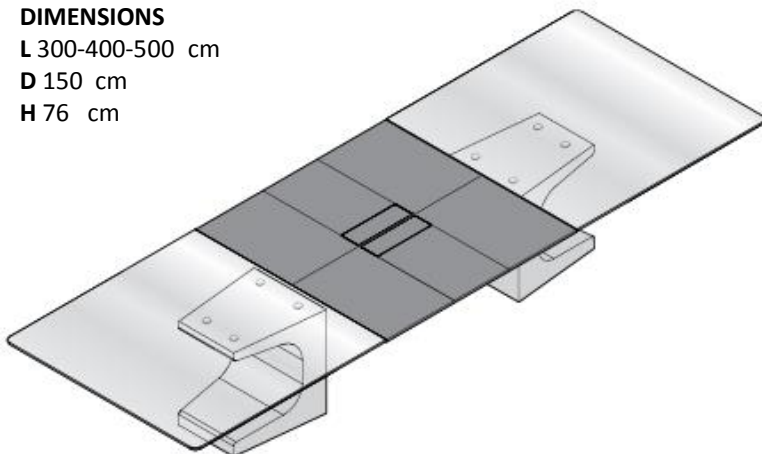

FINISHES

Soft leather: see sample finishing book

Glass: transparent tempered float glass, white, brown, alpha red, silver and titanium back-lacquered acid-etched glass

Base metal: satin stainless steel, natural copper, matt brass

CERTIFICATIONS

The product complies with all the safety requirements and reached the highest level of performance certificates

NIEMEYER 1985 *design Oscar Niemeyer*

Product: SOLID WOOD ELLIPTICAL TABLE WITH TOP ACCESS AND CABLE TRAYS AND SOCKET BOXES

In 1985 Estel commissioned Oscar Niemeyer to create a conference table. What he imagined fully interpreted the dual vocation of the Italian design company, knowing how to smoothly move between home and office. The table, designed both for home interiors and for office executive spaces, is characterized by an important base: one single sculptural leg made in wood covered with brushed steel, with internal counter-weight plates. The top can be either in transparent glass or in a vast choice of solid woods. Presented also in the double version, it can reach a length of 4.5 meters.

A Niemeyer's unmistakable signature, with its metal base in relief projecting a plastic form: this table designed for Estel, is one of the few pieces the Brazilian architect dedicated to interior design.

TECHNICAL FEATURES

Top

The top is made of solid wood with a thickness ranging from 25 mm to 50 mm rounded off on the corners.

Base

The base is made of coated marine plywood; there are counter weight plates inside.

Electrification

Cable passage on the base and top access.

MAINTENANCE

For cleaning use a soft cloth, possibly a microfiber cloth and neutral soap diluted in water.

It is absolutely forbidden to use abrasive powders, acetone, trichloroethylene, ammonia and all agents containing these.

DIMENSIONS

L 300-360-420-480 cm

D 120/100-130/110-140/120 cm

H 76 cm

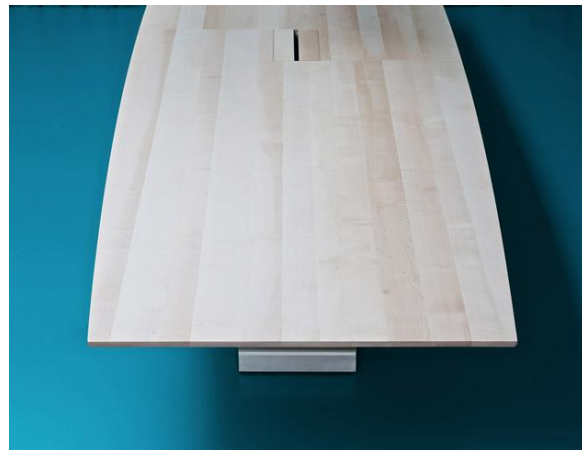
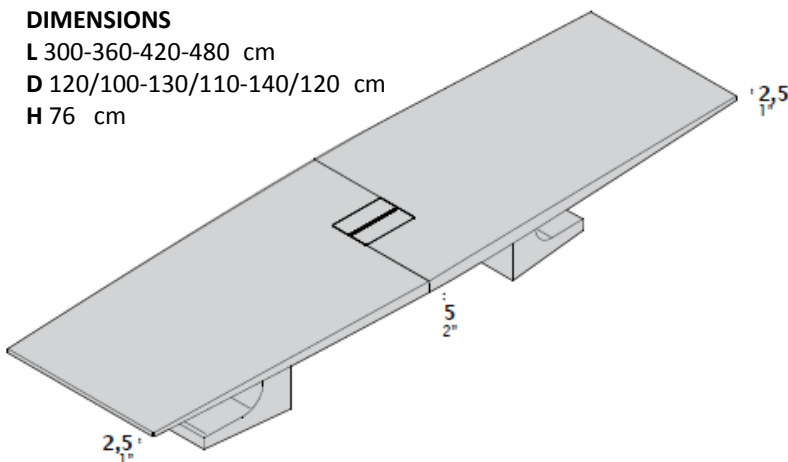

FINISHES

Solid Cat. A: Maple, Barrique oak

Solid Cat. B: Hickory, Wengé, Zebrano

Base metal: satin stainless steel, natural copper, matt brass

CERTIFICATIONS

The product complies with all the safety requirements and reached the highest level of performance certificates

NIEMEYER 1985 *design Oscar Niemeyer*

Product: WOOD VENEER RECTANGULAR TABLE

In 1985 Estel commissioned Oscar Niemeyer to create a conference table. What he imagined fully interpreted the dual vocation of the Italian design company, knowing how to smoothly move between home and office. The table, designed both for home interiors and for office executive spaces, is characterized by an important base: one single sculptural leg made in wood covered with brushed steel, with internal counter-weight plates. The top can be either in transparent glass or in a vast choice of solid woods. Presented also in the double version, it can reach a length of 4.5 meters.

A Niemeyer's unmistakable signature, with its metal base in relief projecting a plastic form: this table designed for Estel, is one of the few pieces the Brazilian architect dedicated to interior design.

TECHNICAL FEATURES

Top

The top is made of wood particleboards rounded off on the corners, wood veneer coated.

Base

The base is made of coated marine plywood; there are counter weight plates inside.

Electrification

Cable passage on the base and top access.

MAINTENANCE

For cleaning use a soft cloth, possibly a microfiber cloth and neutral soap diluted in water.

It is absolutely forbidden to use abrasive powders, acetone, trichloroethylene, ammonia and all agents containing these.

DIMENSIONS

L 600 cm

D 140 cm

H 76 cm

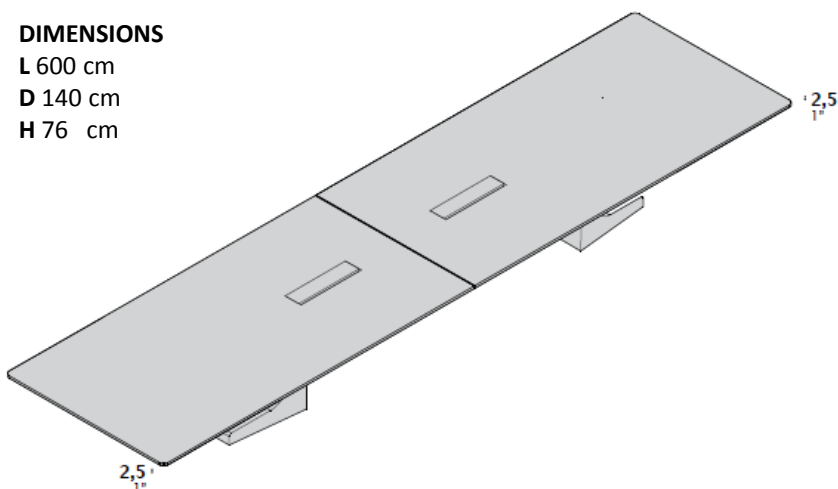

CERTIFICATIONS

The product complies with all the safety requirements and reached the highest level of performance certificates



FINISHES

Wood veneer: light Maple, sage Maple, Ebony, Magnolia, Hickory, Barrique Oak, natural Oak, dark Oak, Tobacco Oak, Wenge, Zebrano Brown

Base metal: satin stainless steel, natural copper, matt brass

NIEMEYER 1985 *design Oscar Niemeyer*

Product: UNDERTOP SWIVEL IPAD, IPHONE HOLDING DRAWER, BATTERY CHARGE, PENS AND SOCKETS ON THE FRONT.

TECHNICAL FEATURES

Structure

It is made of solid wood.

NOTE

The drawer below the top is not available for L230 table.

MAINTENANCE

For cleaning use a soft cloth, possibly a microfiber cloth and neutral soap diluted in water.

It is absolutely forbidden to use abrasive powders, acetone, trichloroethylene, ammonia and all agents containing these

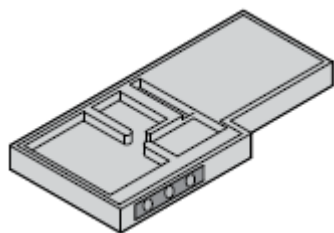

DIMENSIONS

L 900 cm

D 150 cm

H 76 cm

FINISHES

Solid wood Cat. A: Maple, Barrique oak

Solid wood Cat. B: Hickory, Wengé, Zebrano

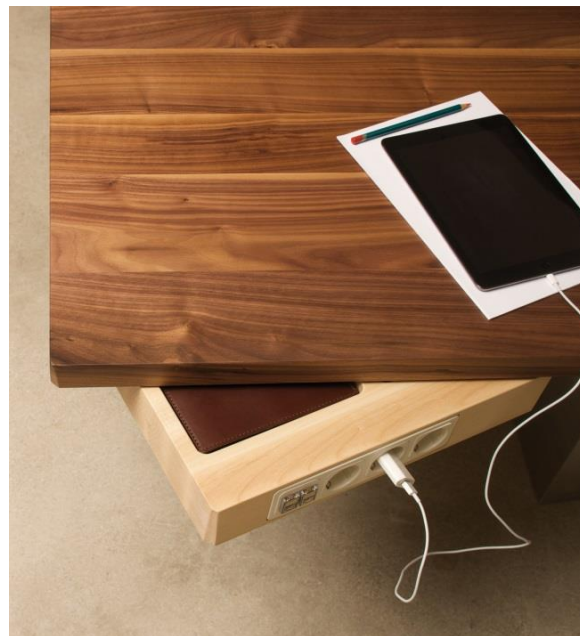

Product: W140 RETURN DESK WITH SERVICE UNIT

Structure

The structure is made of sand lacquered MDF panels.

Top

It is made of 18n mm thick back-lacquered acid-etched

MAINTENANCE

For cleaning use a soft cloth, possibly a microfiber cloth and neutral soap diluted in water.

It is absolutely forbidden to use abrasive powders, acetone, trichloroethylene, ammonia and all agents containing these

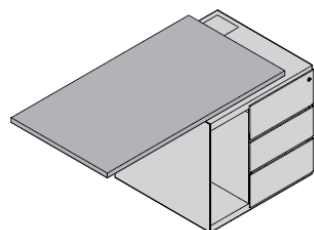

Dx
Rt

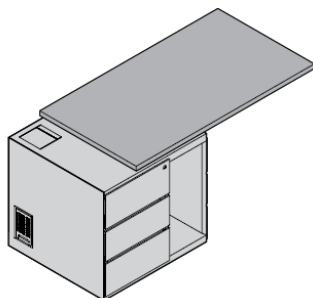

Sx
Lt



DIMENSIONS

Top

L 120cm

D 65 cm

H cm

Furniture

L 70 cm

D 65 cm

H 70 cm

FINISHES

Sand lacquered: light blue, UE white, brown, cedar, ochre yellow, pearl grey, sage grey, amber, orange, alpha red, silver, tobacco, titanium

Glass: transparent tempered float glass, white, brown, alpha red, silver and titanium back-lacquered acid-etched glass

CERTIFICATIONS

The product complies with all the safety requirements and reached the highest level of performance certificates

NIEMEYER 1985 *design Oscar Niemeyer*

Product: ELECTRIFICATION

TECHNICAL FEATURES

All multiple sockets are equipped with 3 mt long wired cable with Schuko socket



TIPO 1



TIPO 2

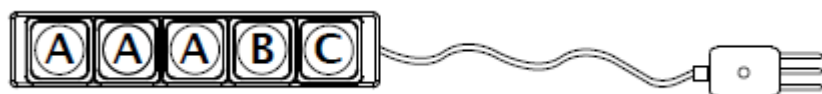

TIPO 3



TIPO 4



A * presa elettrica universale UE
UE universal socket

B n° 2 prese RJ45 passanti cat.6 (dati/telefonia)
n° 2 RJ45 socket cat.6 (data/telephone)

C n° 2 prese USB caricatore 5V
n° 2 USB charger socket 5V

D n° 1 presa HDMI passante (video) + n° 1 presa USB passante
n° 1 HDMI socket (video) + n° 1 USB socket

E presa USB passante estraibile/riavvolgibile L50 cm
W50 cm extractable/retractable USB socket

F presa RJ45 passante estraibile/riavvolgibile L70 cm
W70 cm extractable/retractable RJ45 socket

* a richiesta possono essere forniti standard internazionali diversi da quello europeo
on demand we can also supply international sockets different from UE device

CERTIFICATIONS

The product complies with all the safety requirements and reached the highest level of performance certificates