



*Habitat is a system **Bookcase, Bookshelf, Walk-in Closet, Wardrobe and Freestanding Carabottini** modules hat can be arranged in single pieces or mixed solutions. It is available in **depths of 33.6, 51.6, 59.2 and 61.5 cm, 8 widths and 4 heights**, Habitat allows you to create the same open container model composition, with or without backs, models closed by door. **It is also suitable for bedrooms and for library case in the living room.***

*The extreme flexibility of the system leaves it open to original possibilities.*

*Habitat can be integrated into the **Riguardaroba** wardrobe.*

## From Bookcase to Wardrobe

**LIBRERIA**  
BOOKCASE

**SCAFFALE**  
BOOKSHELF

**CABINA**  
WALK-IN CLOSET

**ARMADIO**  
WARDROBE

**CARABOTTINI PENSILI**  
FREESTANDING CARABOTTINI

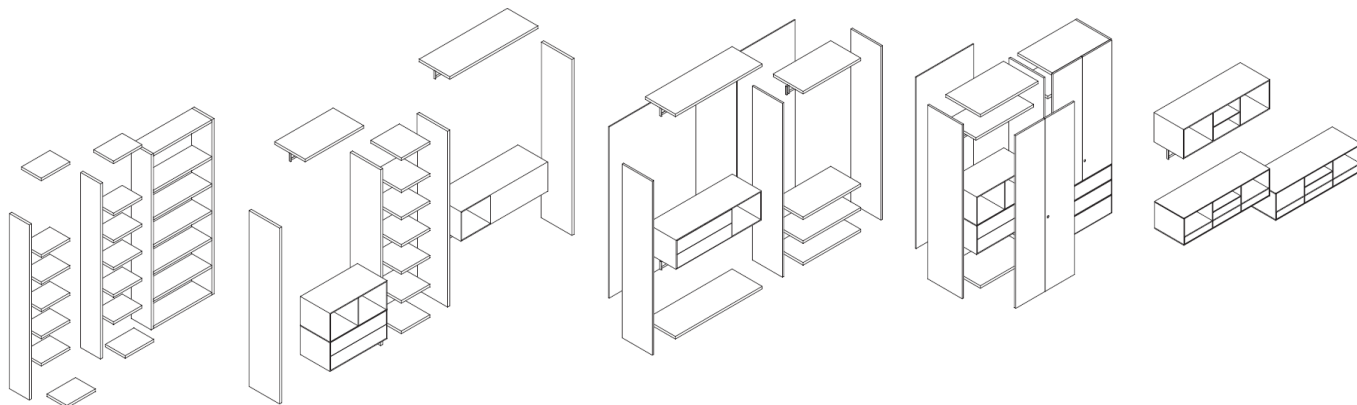

## Technical Characteristics

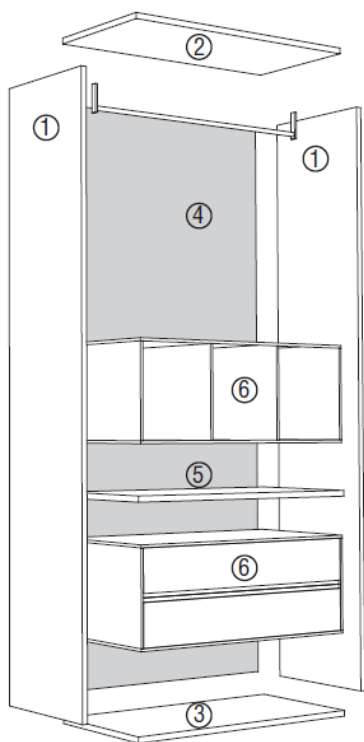

1. **FIANCHI** spessore 2,5 o 3,8 cm. Finiture: Texture, Decor, Laccato.
  2. **CIELO** spessore 3,8 cm. Finiture: Texture, Decor, Laccato.
  3. **FONDO** spessore 3,8 cm. Finiture: Texture, Decor, Laccato.
  4. **SCHIENA** spessore 1,2 cm. Finiture: Texture, Decor, Laccato.
  5. **RIPIANO** spessore 2,5 o 3,8 cm. Finiture: Texture, Decor, Laccato.
  6. **CARABOTTINO** contenitore a giorno o a cassetti. Finiture: Texture, Decor, Laccato.
- ANTE BATTENTI** Anteprima, Bianco, Sketch.

## Finishes

Texture melamine: Delavè – Comfort

Decor melamine: Rovere Scuro – Magnolia – Olmo Perla

Lacquered: all colours available

# HABITAT

## LIBRERIA

### BOOKCASE

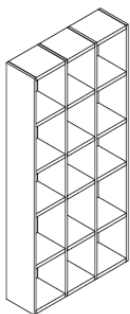

#### PROFONDITA' 33,6

33.6 DEPTH

- 2 fianchi terminali  
2 end panels
- 2 fianchi intermedi  
2 intermediate panels
- 12 ripiani sp. 2,5/ 3,8 cm  
12 shelves 2.5/ 3.8 cm thick
- 3 cieli + 3 fondi  
3 tops + 3 bottoms

## SCAFFALE (senza schiena)

### BOOKSHELF (without back)

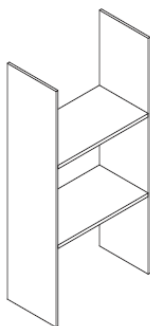

#### PROFONDITA' 51,6

51.6 DEPTH

- 2 fianchi terminali  
2 end panels
- 2 ripiani sp. 3,8 cm  
2 shelves 3.8 cm thick

#### PROFONDITA' 59,2

59.2 DEPTH

- 2 fianchi terminali  
2 end panels
- 2 ripiani sp. 3,8 cm  
2 shelves 3.8 cm thick

## CABINA (con schiena)

### WALK-IN CLOSET (with back)

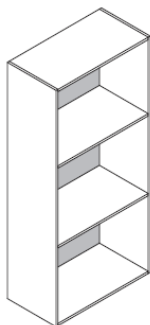

#### PROFONDITA' 33,6

33.6 DEPTH

- 2 fianchi terminali  
2 end panels
- 2 ripiani sp. 2,5/ 3,8 cm  
2 shelves 2.5/ 3.8 cm thick
- 1 cielo + 1 fondo  
1 top +1 bottom
- 1 schiena  
1 back

#### PROFONDITA' 51,6

51.6 DEPTH

- 2 fianchi terminali  
2 end panels
- 2 ripiani sp. 2,5/ 3,8 cm  
2 shelves 2.5/ 3.8 cm thick
- 1 cielo + 1 fondo  
1 top +1 bottom
- 1 schiena  
1 back

#### PROFONDITA' 59,2

59.2 DEPTH

- 2 fianchi terminali  
2 end panels
- 2 ripiani sp. 2,5/ 3,8 cm  
2 shelves 2.5/ 3.8 cm thick
- 1 cielo + 1 fondo  
1 top +1 bottom
- 1 schiena  
1 back

## ARMADIO

### WARDROBE

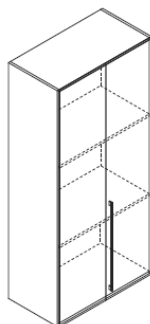

#### PROFONDITA' 54 \*

54 DEPTH \*

- 2 fianchi terminali  
2 end panels
- 2 ripiani sp. 2,5/ 3,8 cm  
2 shelves 2.5/ 3.8 cm thick
- 1 cielo + 1 fondo  
1 top +1 bottom
- 1 schiena  
1 back
- 2 ante sp. 2,2 cm  
2 doors 2.2 cm thick

#### PROFONDITA' 61,5

61.5 DEPTH

- 2 fianchi terminali  
2 end panels
- 2 ripiani sp. 2,5/ 3,8 cm  
2 shelves 2.5/ 3.8 cm thick
- 1 cielo + 1 fondo  
1 top +1 bottom
- 1 schiena  
1 back
- 2 ante sp. 2,2 cm  
2 doors 2.2 cm thick

\* La P51,6 si può chiudere con ante solo in presenza di fianchi sp. 2,5 cm e attrezzatura a ripiani  
D51.6 can be equipped with doors only in presence of 2.5 mm thick sides and of shelves.

# HABITAT

## SCAFFALE (senza schiena)

BOOKSHELF (without back)

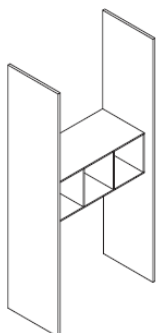

**PROFONDITA' 33,6**

33.6 DEPTH

2 fianchi terminali  
2 end panels

1 carabottino (a giorno o con 2 cassetti)  
1 carabottino (open fronted or with 2 drawers)

**PROFONDITA' 51,6**

51.6 DEPTH

2 fianchi terminali  
2 end panels

1 carabottino (a giorno o con 2 cassetti)  
1 carabottino (open fronted or with 2 drawers)

**PROFONDITA' 59,2**

59.2 DEPTH

2 fianchi terminali  
2 end panels

1 carabottino (a giorno o con 2 cassetti)  
1 carabottino (open fronted or with 2 drawers)

## CABINA (con schiena)

WALK-IN CLOSET (with back)

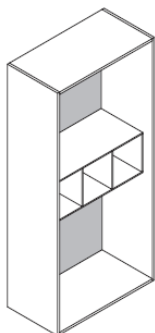

**PROFONDITA' 51,6**

51.6 DEPTH

2 fianchi terminali  
2 end panels

1 cielo + 1 fondo  
1 top +1 bottom

1 carabottino (a giorno o con 2 cassetti)  
1 carabottino (open fronted or with 2 drawers)

1 schiena  
1 back

**PROFONDITA' 59,2**

59.2 DEPTH

2 fianchi terminali  
2 end panels

1 cielo + 1 fondo  
1 top +1 bottom

1 carabottino (a giorno o con 2 cassetti)  
1 carabottino (open fronted or with 2 drawers)

1 schiena  
1 back

## ARMADIO

WARDROBE

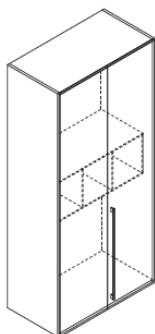

**PROFONDITA' 61,5**

61.5 DEPTH

2 fianchi terminali  
2 end panels

1 cielo + 1 fondo  
1 top +1 bottom

1 carabottino (a giorno o con 2 cassetti)  
1 carabottino (open fronted or with 2 drawers)

1 schiena  
1 back

2 ante sp. 2,2 cm  
2 doors 2.2 cm thick

## SCAFFALE (senza schiena)

BOOKSHELF (without back)

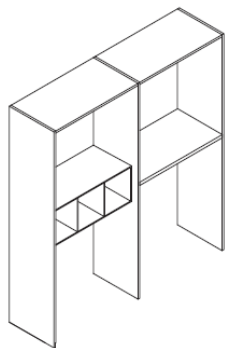

**PROFONDITA' 33,6**  
33.6 DEPTH

2 fianchi terminali  
2 end panels  
1 fianco intermedio  
1 intermediate side panel  
1 carabottino  
(a giorno)  
1 carabottino  
(open fronted)  
1 ripiano sp. 2,5/ 3,8 cm  
1 shelf 2.5/ 3.8 cm thick  
2 cieli  
2 tops

**PROFONDITA' 51,6**  
51.6 DEPTH

2 fianchi terminali  
2 end panels  
1 fianco intermedio  
1 intermediate side panel  
1 carabottino  
(a giorno o con 2 cassetti)  
1 carabottino  
(open fronted or with 2 drawers)  
1 ripiano sp. 2,5/ 3,8 cm  
1 shelf 2.5/ 3.8 cm thick  
2 cieli  
2 tops

**PROFONDITA' 59,2**  
59.2 DEPTH

2 fianchi terminali  
2 end panels  
1 fianco intermedio  
1 intermediate side panel  
1 carabottino  
(a giorno o con 2 cassetti)  
1 carabottino  
(open fronted or with 2 drawers)  
1 ripiano sp. 2,5/ 3,8 cm  
1 shelf 2.5/ 3.8 cm thick  
2 cieli  
2 tops

## CABINA (con schiena)

WALK-IN CLOSET (with back)

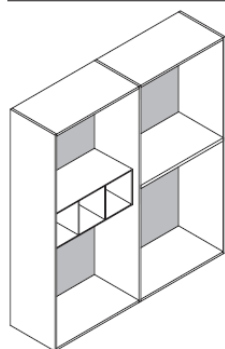

**PROFONDITA' 33,6**  
33.6 DEPTH

2 fianchi terminali  
2 end panels  
1 fianco intermedio  
1 intermediate side panel  
1 carabottino  
(a giorno)  
1 carabottino  
(open fronted)  
1 ripiano sp. 2,5/ 3,8 cm  
1 shelf 2.5/ 3.8 cm thick  
2 cieli + 2 fondi  
2 tops + 2 bottoms  
2 schiene  
2 backs

**PROFONDITA' 51,6**  
51.6 DEPTH

2 fianchi terminali  
2 end panels  
1 fianco intermedio  
1 intermediate side panel  
1 carabottino  
(a giorno o con 2 cassetti)  
1 carabottino  
(open fronted or with 2 drawers)  
1 ripiano sp. 2,5/ 3,8 cm  
1 shelf 2.5/ 3.8 cm thick  
2 cieli + 2 fondi  
2 tops + 2 bottoms  
2 schiene  
2 backs

**PROFONDITA' 59,2**  
59.2 DEPTH

2 fianchi terminali  
2 end panels  
1 fianco intermedio  
1 intermediate side panel  
1 carabottino  
(a giorno o con 2 cassetti)  
1 carabottino  
(open fronted or with 2 drawers)  
1 ripiano sp. 2,5/ 3,8 cm  
1 shelf 2.5/ 3.8 cm thick  
2 cieli + 2 fondi  
2 tops + 2 bottoms  
2 schiene  
2 backs

## ARMADIO

WARDROBE

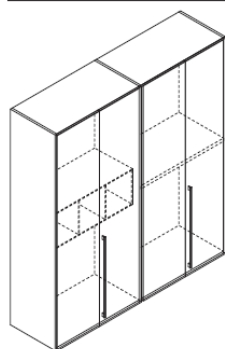

**PROFONDITA' 61,5**  
61.5 DEPTH

2 fianchi terminali  
2 end panels  
1 fianco intermedio  
1 intermediate side panel  
1 carabottino  
(a giorno o con 2 cassetti)  
1 carabottino  
(open fronted or with 2 drawers)  
1 ripiano sp. 2,5/ 3,8 cm  
1 shelf 2.5/ 3.8 cm thick  
2 cieli + 2 fondi  
2 tops + 2 bottoms  
2 schiene  
2 backs  
4 ante sp. 2,2 cm  
4 doors 2.2 cm thick

## CARABOTTINI PENSILI FREESTANDING CARABOTTINI

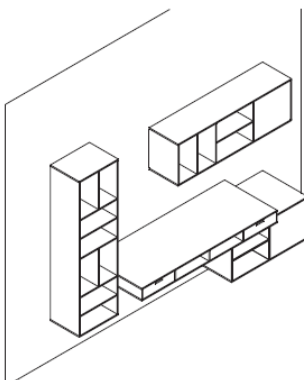

### PROFONDITA' 32 32 DEPTH

- 1 carabottino a giorno verticale
- 1 vertical carabottino open fronted
- 1 carabottino orizzontale a giorno e anta
- 1 horizontal carabottino open fronted and wing door

### PROFONDITA' 50 50 DEPTH

- 1 carabottino orizzontale con 1 anta e 1 vano a giorno
- 1 horizontal carabottino with 1 wing door and 1 open fronted

### PROFONDITA' 59,2

- 59,2 DEPTH
- 1 consolle
- 1 consolle

## CARABOTTINI PENSILI FREESTANDING CARABOTTINI

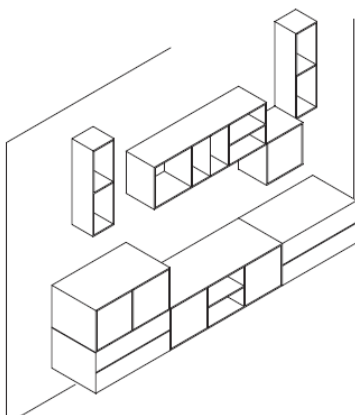

### PROFONDITA' 24 24 DEPTH

- 2 carabottini a giorno verticale
- 2 vertical carabottini open fronted

### PROFONDITA' 32 32 DEPTH

- 1 carabottino ad anta
- 1 carabottino with wing door
- 1 carabottino orizzontale a giorno
- 1 horizontal carabottino open fronted

### PROFONDITA' 50

- 50 DEPTH
- 2 carabottini orizzontali a cassetti
- 2 horizontal carabottini with drawers
- 1 carabottino orizzontale 2 ante e 1 vano a giorno
- 1 horizontal carabottino with 2 wing doors and 1 open fronted
- 1 carabottino 2 ante
- 1 carabottino with 2 wing doors

## CARABOTTINI PENSILI FREESTANDING CARABOTTINI

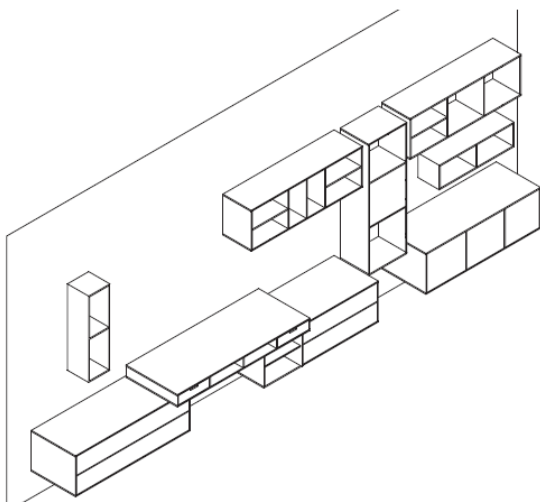

### PROFONDITA' 24 24 DEPTH

- 1 carabottino a giorno verticale
- 1 vertical carabottino open fronted
- 1 carabottino a giorno orizzontale
- 1 horizontal carabottino open fronted

### PROFONDITA' 32 32 DEPTH

- 2 carabottini a giorno orizzontale
- 2 horizontal carabottini open fronted
- 1 carabottino verticale con 1 anta e 2 vani a giorno
- 1 vertical carabottino with 1 door and 2 open fronted

### PROFONDITA' 50

- 50 DEPTH
- 1 carabottino orizzontale a cassetti
- 1 horizontal carabottino with drawers
- 1 carabottino orizzontale a cassetti e vano a giorno
- 1 horizontal carabottino with drawers and open fronted
- 1 carabottino orizzontale ad ante
- 1 horizontal carabottino with wing doors

### PROFONDITA' 59,2 59,2 DEPTH

- 1 consolle
- 1 consolle

# HABITAT

## CARABOTTINI PENSILI FREESTANDING CARABOTTINI

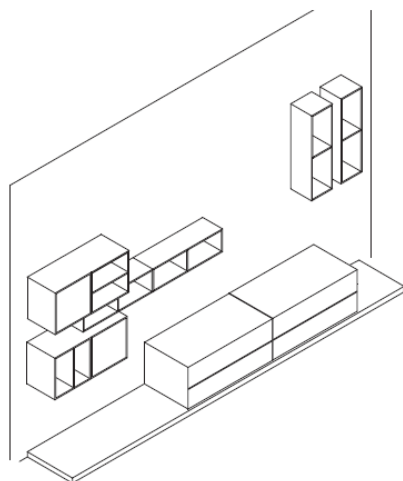

### PROFONDITA' 24

24 DEPTH

2 carabottini a giorno verticali  
2 vertical carabottini open fronted  
2 carabottini a giorno orizzontali  
2 horizontal carabottini open fronted

### PROFONDITA' 32

32 DEPTH

2 carabottini orizzontali 1 anta e 1 vano a giorno  
2 horizontal carabottini 1 wing door and 1 open fronted

### PROFONDITA' 50

50 DEPTH

2 carabottino orizzontali a cassetti  
2 horizontal carabottini with drawers

## CARABOTTINI PENSILI FREESTANDING CARABOTTINI

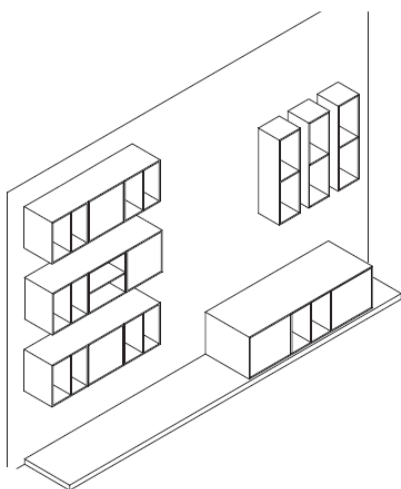

### PROFONDITA' 24

24 DEPTH

3 carabottini a giorno verticali  
3 vertical carabottini open fronted

### PROFONDITA' 32

32 DEPTH

3 carabottini orizzontali 1 anta e 2 vani a giorno  
3 horizontal carabottini 1 wing door and 2 open fronted

### PROFONDITA' 50

50 DEPTH

1 carabottino orizzontale 2 ante e 1 vano a giorno  
1 horizontal carabottino with 2 wing doors and 1 open fronted

## CARABOTTINI PENSILI FREESTANDING CARABOTTINI

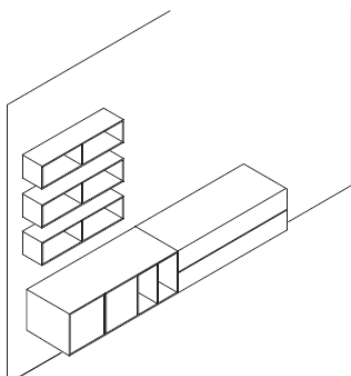

### PROFONDITA' 24

24 DEPTH

3 carabottini a giorno orizzontali  
3 horizontal carabottini open fronted

### PROFONDITA' 50

50 DEPTH

1 carabottino orizzontale 2 ante e 1 vano a giorno  
1 horizontal carabottino with 2 wing doors and 1 open fronted  
1 carabottino orizzontale 2 cassetti  
1 horizontal carabottino with 2 drawers

# HABITAT

## STRUCTURE

### TERMINAL SIDES

Thickness 2,5 – 3,8 cm

Depth 33,6 – 51,6 – 59,2 cm

Height 219 – 239 – 258 – h ceiling (maximum 298) cm

### INTERMEDIATE

Thickness 2,5 – 3,8 cm

Depth 33,6 – 51,6 – 59,2 cm

Height 219 – 239 – 258 – h ceiling (maximum 298) cm

### CIELO

Thickness 3,8 cm

Width 41,0 – 48,3 – 55,5 – 84,5 – 99 – 113,5 – 128 – 149,8 cm

Depth 33,6 – 51,6 – 59,2 cm

### FONDO

Thickness 3,8 cm

Width 41,0 – 48,3 – 55,5 – 84,5 – 99 – 113,5 – 128 – 149,8 cm

Depth 33,6 – 51,6 – 59,2 cm

### RIPIANO

Thickness 2,5 – 3,8 cm

Width 41,0 – 48,3 – 55,5 – 84,5 – 99 – 113,5 – 128 – 149,8 cm

Depth 33,6 – 51,6 – 59,2 cm

### SCHIENA

Thickness 1,2 cm

Width 41,0 – 48,3 – 55,5 – 84,5 – 99 – 113,5 – 128 – 149,8 cm

Height 219 – 239 – 258 – h ceiling (maximum 298) cm



## Carabottini

### VANO A GIORNO OPEN COMPARTMENT



Tipo B  
Type B

larghezza	profondità	altezza
width	depth	height
48,3	32	43,2
48,3	50	43,2
55,5	50	43,2

### 2 CASSETTI + VANO A GIORNO 2 DRAWERS + OPEN COMPARTMENT



Tipo E  
Type E

larghezza	profondità	altezza
width	depth	height
48,3	50	81,6
55,5	50	81,6

### VANO A GIORNO OPEN COMPARTMENT

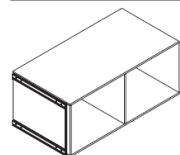

Tipo B  
Type B

larghezza	profondità	altezza
width	depth	height
84,5	32	43,2
99	32	43,2
84,5	50	43,2
99	50	43,2

### 2 CASSETTI + VANO A GIORNO 2 DRAWERS + OPEN COMPARTMENT

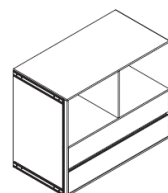

Tipo E  
Type E

larghezza	profondità	altezza
width	depth	height
84,5	50	81,6
99	50	81,6

### VANO A GIORNO OPEN COMPARTMENT

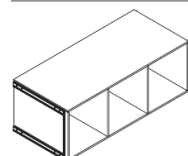

Tipo B  
Type B

larghezza	profondità	altezza
width	depth	height
128	32	43,2
149,8	32	43,2
113,5	50	43,2
128	50	43,2
149,8	50	43,2

### 2 CASSETTI + VANO A GIORNO 2 DRAWERS + OPEN COMPARTMENT

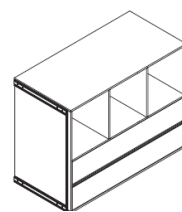

Tipo E  
Type E

larghezza	profondità	altezza
width	depth	height
113,5	50	81,6
128	50	81,6

### VANO A GIORNO OPEN COMPARTMENT

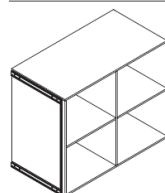

Tipo H  
Type H

larghezza	profondità	altezza
width	depth	height
84,5	32	81,6
84,5	50	81,6
99	50	81,6

### 2 CASSETTI 2 DRAWERS

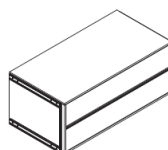

Tipo A  
Type A

larghezza	profondità	altezza
width	depth	height
48,3	50	43,2
55,5	50	43,2
84,5	50	43,2
99	50	43,2
113,5	50	43,2
128	50	43,2

### VANO A GIORNO OPEN COMPARTMENT

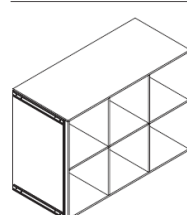

Tipo H  
Type H

larghezza	profondità	altezza
width	depth	height
128	32	81,6
149,8	32	81,6
113,5	50	81,6
128	50	81,6
149,8	50	81,6

### VANO A GIORNO + 2 CASSETTI OPEN COMPARTMENT + 2 DRAWERS



Tipo G  
Type G

larghezza	profondità	altezza
width	depth	height
84,5	50	43,2
99	50	43,2
113,5	50	43,2
128	50	43,2
149,8	50	43,2

### 2 CASSETTI + VANO A GIORNO 2 DRAWERS + OPEN COMPARTMENT

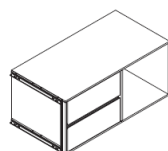

Tipo F  
Type F

larghezza	profondità	altezza
width	depth	height
84,5	50	43,2
99	50	43,2
113,5	50	43,2
128	50	43,2
149,8	50	43,2

## Freestanding Carabottini

### VANO A GIORNO OPEN COMPARTMENT

larghezza profondità altezza  
width depth height

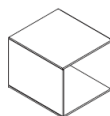

Tipo B  
Type B

45,9	24	24
53,1	24	24
45,9	32	43,2
53,1	32	43,2

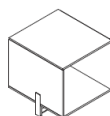

45,9	50	43,2
53,1	50	43,2

con asta appendiabiti - with clothes tod

### VANO A GIORNO OPEN COMPARTMENT

larghezza profondità altezza  
width depth height

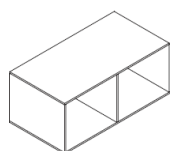

Tipo B  
Type B

82,1	24	24
96,6	24	24
82,1	32	43,2
96,6	32	43,2

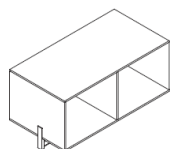

82,1	50	43,2
96,6	50	43,2

con asta appendiabiti - with clothes tod

### VANO A GIORNO OPEN COMPARTMENT

larghezza profondità altezza  
width depth height

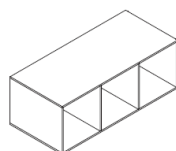

Tipo B  
Type A

111,1	24	24
111,1	32	43,2
125,6	32	43,2
147,4	32	43,2

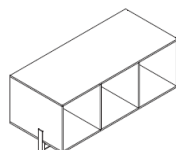

111,1	50	43,2
125,6	50	43,2
147,4	50	43,2

con asta appendiabiti - with clothes tod

### 2 CASSETTI 2 DRAWERS

larghezza profondità altezza  
width depth height

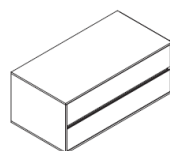

Tipo A  
Type A

45,9	50	43,2
53,1	50	43,2
82,1	50	43,2
96,6	50	43,2
111,1	50	43,2
125,5	50	43,2

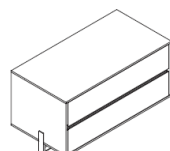

45,9	50	43,2
53,1	50	43,2
82,1	50	43,2
96,6	50	43,2
111,1	50	43,2
125,5	50	43,2

con asta appendiabiti - with clothes tod

### 2 CASSETTI + 2 VANI A GIORNO 2 DRAWERS + 2 OPEN COMPARTMENTS

larghezza profondità altezza  
width depth height

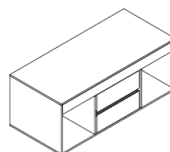

Tipo M  
Type M

111,1	50	43,2
125,6	50	43,2
147,4	50	43,2

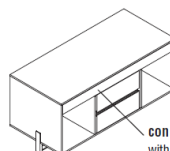

con cassetto alto  
with high drawer

con asta appendiabiti - with clothes tod

111,1	50	43,2
125,6	50	43,2
147,4	50	43,2

per frontali laccati in finitura diversi  
for lacquered fronts with different color f

### 2 CASSETTI + 2 VANI A GIORNO 2 DRAWERS + 2 OPEN COMPARTMENTS

larghezza profondità altezza  
width depth height

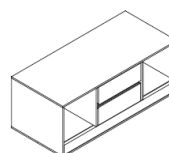

Tipo M  
Type M

111,1	50	43,2
125,6	50	43,2
147,4	50	43,2

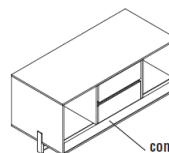

con cassetto basso  
with low drawer

con asta appendiabiti - with clothes to

111,1	50	43,2
125,6	50	43,2
147,4	50	43,2

per frontali laccati in finitura div  
for lacquered fronts with different col

### VANO A GIORNO OPEN COMPARTMENT

larghezza profondità altezza  
width depth height



Tipo N  
Type N

24	24	45,9
43,2	32	45,9
43,2	50	45,9

### VANO A GIORNO OPEN COMPARTMENT

larghezza profondità altezza  
width depth height



Tipo N  
Type N

24	24	82,1
24	24	96,6
43,2	32	82,1
43,2	32	96,6
43,2	50	82,1
43,2	50	96,6

### VANO A GIORNO OPEN COMPARTMENT

larghezza profondità altezza  
width depth height



Tipo N  
Type N

24	24	111,1
43,2	32	111,1
43,2	32	125,6
43,2	32	147,4
43,2	50	111,1
43,2	50	125,6
43,2	50	147,4

## Corner module

### MODULO ANGOLO A GIORNO P32/ P59,2/ P51,6

OPEN CORNER MODULE D32/ D59.2/ D51.6

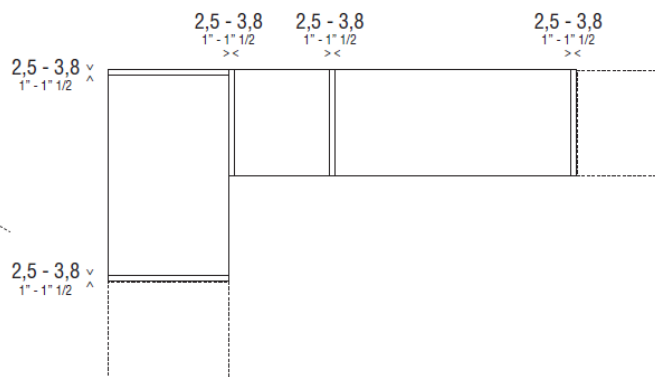
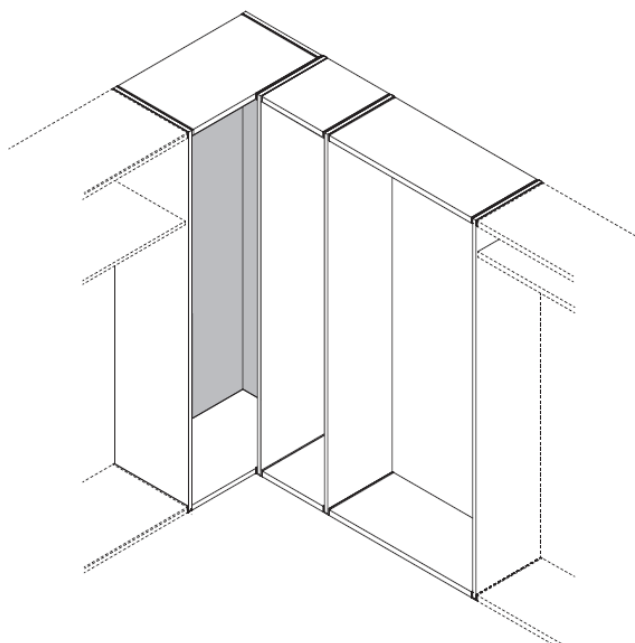

### MODULO AD ANGOLO CHIUSO P59,2/ P51,6

CORNER CLOSED MODULE D59.2/ D51.6

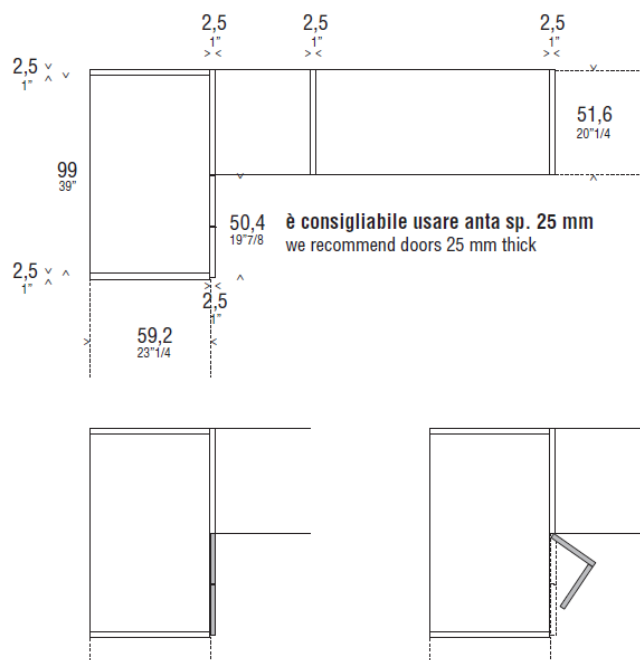
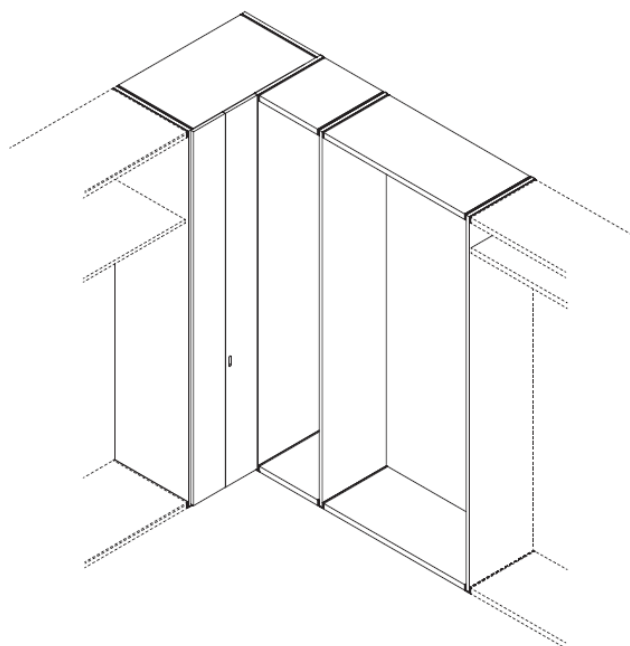

### Closed corner element

The closed corner element of Habitat is obtained with a W. 99 module and a W. 51.6 module plus side panels 25 mm thick. See drawing.

In this way it is possible to close the module with a standard Anteprima or Reverso door W. 50.4.

## Corner module

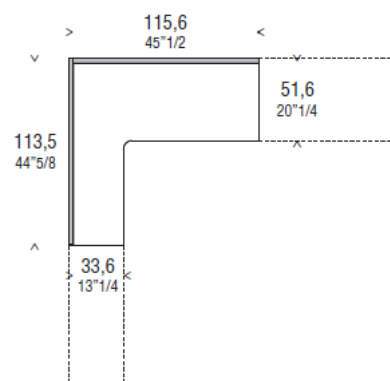
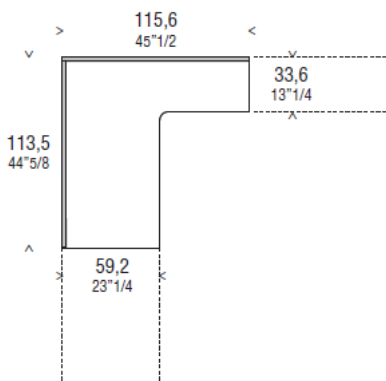
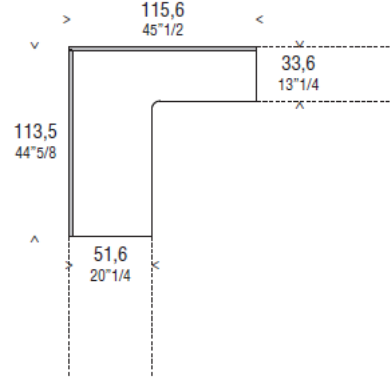
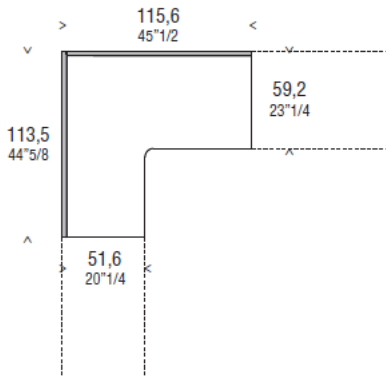
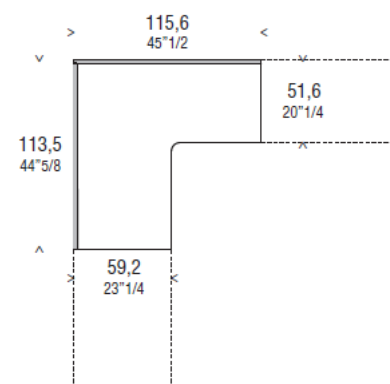
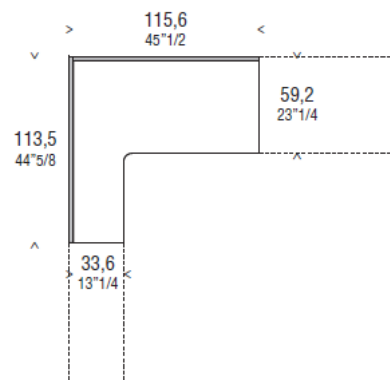
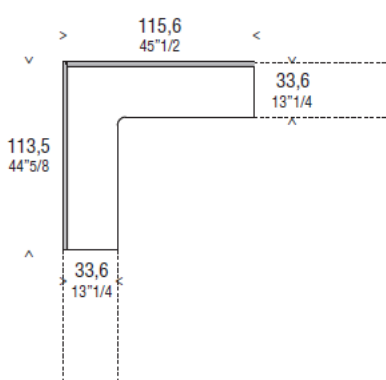
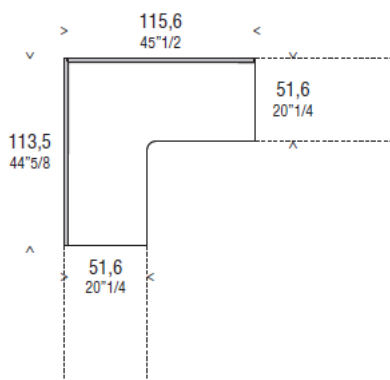
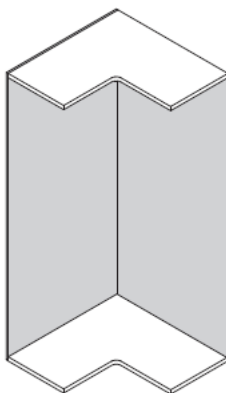
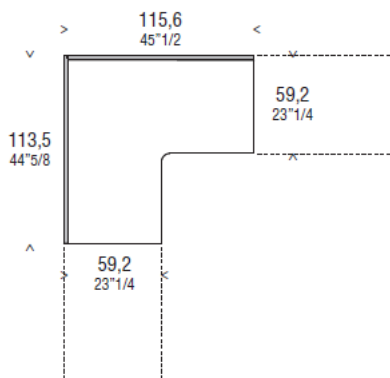

## Pull-out column

### COLONNA CESTONE BIANCHERIA

COLUMN WITH LAUNDRY BASKET

larghezza profondità altezza

width depth height

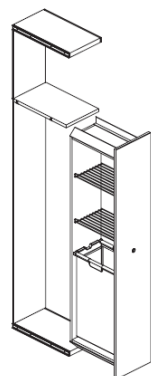

frontale legno con maniglia Linea	33,8	51,6	239
wooden front with Linea handle	33,8	51,6	258
	33,8	51,6	H soffitto

frontale specchio con maniglia Premi - Apri	33,8	51,6	239
mirror front with Push - Pull handle	33,8	51,6	258
	33,8	51,6	H soffitto

**1 specchio**  
**2 griglie**  
**1 cestone**

1 mirror  
2 grids  
1 laundry basket

### COLONNA TEMPO LIBERO

SPARE TIME COLUMN

larghezza profondità altezza

width depth height

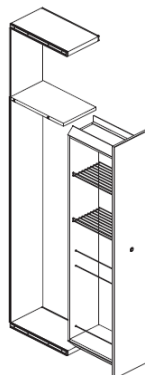

frontale legno con maniglia Linea	33,8	51,6	239
wooden front with Linea handle	33,8	51,6	258
	33,8	51,6	H soffitto

frontale specchio con maniglia Premi - Apri	33,8	51,6	239
mirror front with Push - Pull handle	33,8	51,6	258
	33,8	51,6	H soffitto

**1 specchio**  
**2 griglie**  
**3 aste**

1 mirror  
2 grids  
3 rods

### COLONNA RIPIANI

COLUMN WITH SHELVES

larghezza profondità altezza

width depth height

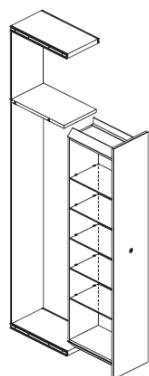

frontale legno con maniglia Linea	33,8	51,6	239
wooden front with Linea handle	33,8	51,6	258
	33,8	51,6	H soffitto

frontale specchio con maniglia Premi - Apri	33,8	51,6	239
mirror front with Push - Pull handle	33,8	51,6	258
	33,8	51,6	H soffitto

**1 specchio**  
**5 ripiani vetro**

1 mirror  
5 glazed shelves

### COLONNA PORTAOGGETTI

PERSONAL CASE COLUMN

larghezza profondità altezza

width depth height

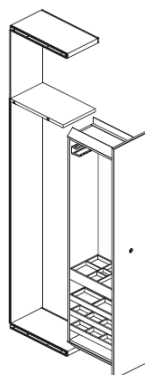

frontale legno con maniglia Linea	33,8	51,6	239
wooden front with Linea handle	33,8	51,6	258
	33,8	51,6	H soffitto

frontale specchio con maniglia Premi - Apri	33,8	51,6	239
mirror front with Push - Pull handle	33,8	51,6	258
	33,8	51,6	H soffitto

**1 specchio**  
**1 porta cravatte**  
**1 portagioie**  
**1 cassetto segreto**  
**3 vassoi**

1 mirror  
1 tie rack  
1 beauty case  
1 secret drawer  
3 trays

### COLONNA SCARPIERA - SANIFICATORE

COLUMN WITH SHOE RACK - SANIFICATION MACHINE

larghezza profondità altezza

width depth height

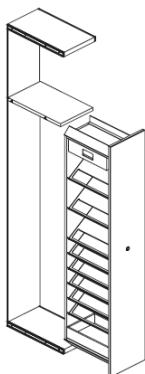

frontale legno con maniglia Linea	33,8	51,6	239
wooden front with Linea handle	33,8	51,6	258
	33,8	51,6	H soffitto

frontale specchio con maniglia Premi - Apri	33,8	51,6	239
mirror front with Push - Pull handle	33,8	51,6	258
	33,8	51,6	H soffitto

**1 specchio**  
**1 sanificatore**  
**8 ripiani scarpiera**  
**- 16/20 paia di scarpe**  
**1 porta spazzole**

1 mirror  
1 sanitification machine  
8 shoe racks  
- 16/ 20 pair of shoes  
1 brush case

# HABITAT

## Wardrobe column with drawers

### COLONNA ARMADIO CON CASSETTI WARDROBE COLUMN WITH DRAWERS

larghezza profondità altezza  
width depth height

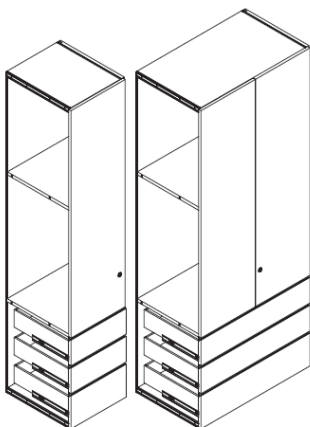

width	depth	height
48,3	61,5	239
48,3	61,5	258
99	61,5	239
99	61,5	258

## Wing doors for sides d. 51,6 e 59,2 cm

ANTEPRIMA  
BIANCO  
SKETCH  
REVERSO

## Console and desk

### CONSOLLE CONSOLLE

larghezza profondità altezza  
width depth height

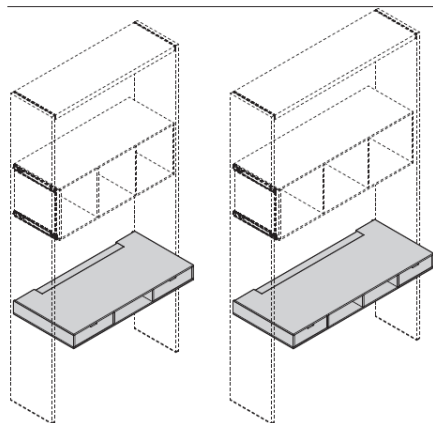

width	depth	height
128	59,2	12
149,8	59,2	12

### SCRITTOIO DESK

larghezza profondità altezza  
width depth height

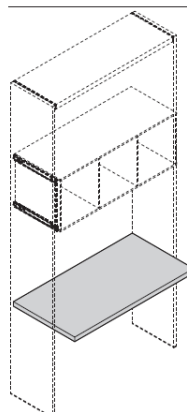

width	depth	height
99	51,6	3,8
128	51,6	3,8

### SCHIENA PER CONSOLLE E SCRITTOIO BACK FOR CONSOLLE AND DESK

larghezza profondità altezza  
width depth height

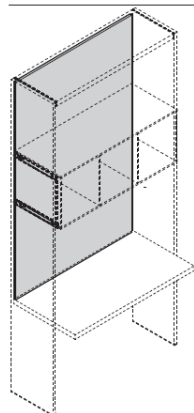

per H239 for H239	99	1,2	--
	128	1,2	--
	149,8	1,2	--
per H258 for H258	99	1,2	--
	128	1,2	--
	149,8	1,2	--
per H soffitto for H ceiling	99	1,2	--
	128	1,2	--
	149,8	1,2	--

# HABITAT

## Internal equipments:

- **Glazed shelves** TH. 8 mm, D. 43 or 55 cm
- **Pull-out shelves** in melamine or lacquered snow white
- **Pull-out trouser rack Shelves** in melamine or lacquered snow white
- **Shoes rack** in comfort ord white varnished metal, W. 41 or 48,3 cm
- **Pull-out tray**
- **Clothes rod**
- **Pull-out clothes rod**

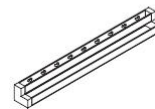
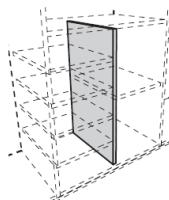
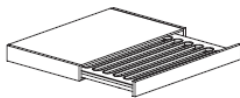
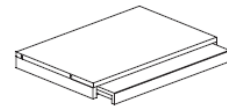

• **Sanification machine:** *Thanks to the employment of one ions dispenser combined with an anti-germicide lamp, this system deodorizes and sterilizes clothes, shoes or any other object placed to its inside in absolutely innocuous way for the man. It directly takes part on organic particles presents in textile materials, destroying them; in addition it eliminates smells by oxidation of its chemical flown compounds. Its is equipped with a programmable timer.*

- **7 arms trouser rack**
- **Pull-out clothes hanger rail** for fitting to top
- **Clothes hanger pole**
- **Pull-out belt-rack** for sitting to side
- **Pull-out tie-rack** for sitting to side
- **Fixed tie-rack** for sitting to side
- **Ties-rack**
- **Fixed internal mirror**, H. 182 L.31 for doors W. 43 cm and H. 182 W. 42 for doors W.50 cm

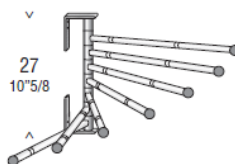
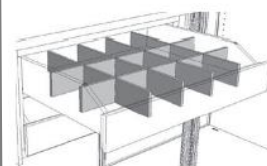
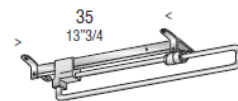
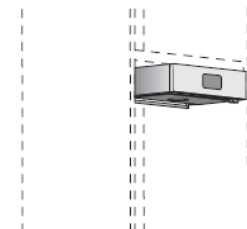
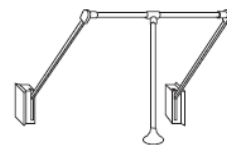
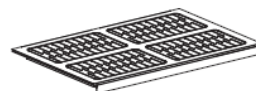
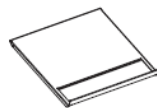

## Rules for lamps use

On the Habitat's tops and shelves, there can be packed some aluminium lamps with LED illumination, and the switching on is regulated by a sensor. In presence of 6 or more lamps, it is necessary to use 2 power units, since each one has 6 entry.

To feed the lamps use the wired LED driver with max load at least equal to sum of loads of single lamps.

