

Credenze

Design by Estel R&D

The Credenze system is made up of several containers suitable for managerial or prestigious reception spaces. They have an original and light design with 30 mm (1"1/8) thickness, TV stand and monitor. All sideboards can be combined with E-Wall Boiserie.

All the elements rest on the metal base in Carbon Glacé or Luxury metal painted finish.



TECHNICAL FEATURES



Structure and fronts

Structure made of particle panels available in Sablè Lacquered or Veneer finish.

Base

Base made of metal structure in matt Carbon Glacé painted Metal or Luxury Metal finish.

Boiserie and accessories

La Boiserie and its accessories are available in Sablè Lacquered or Veneer finishes.

All sideboards can be equipped with a basket.

TECHNICAL FEATURES

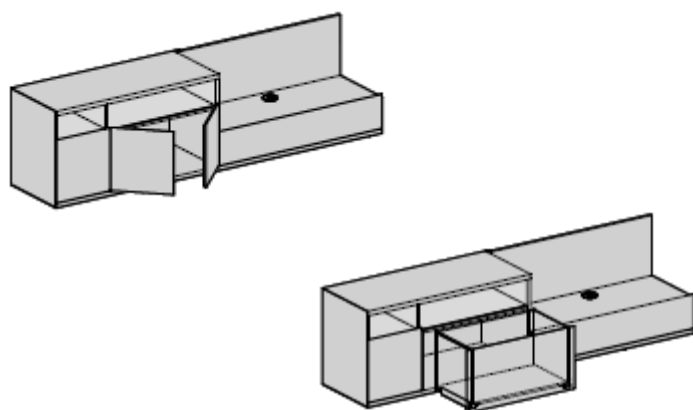
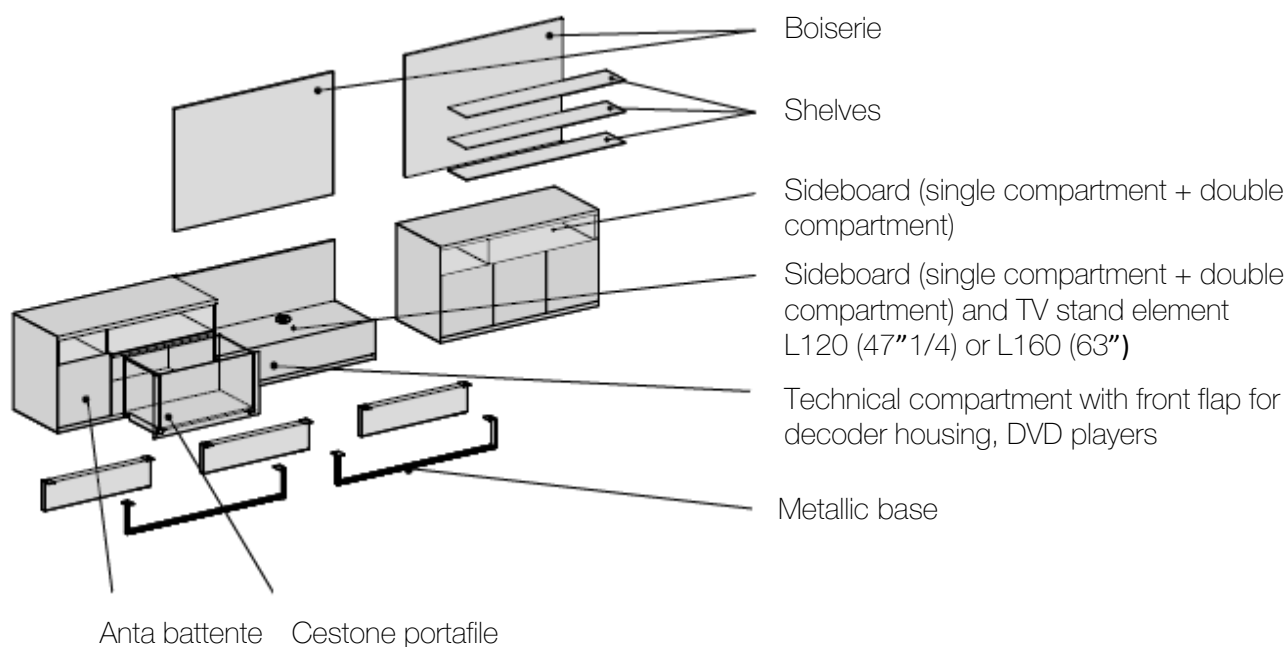

The double compartment L80 (31"1/2) can be closed by two hinged doors or by an extractable file basket. The single compartment L40 (15"3/4) can only be closed by a swing door.

The surface of the lowered TV stand element can be in Ceramic, as well as the shelf in the open area; quote on request. Each compartment can be equipped with a lock.

ELECTRIFICATION

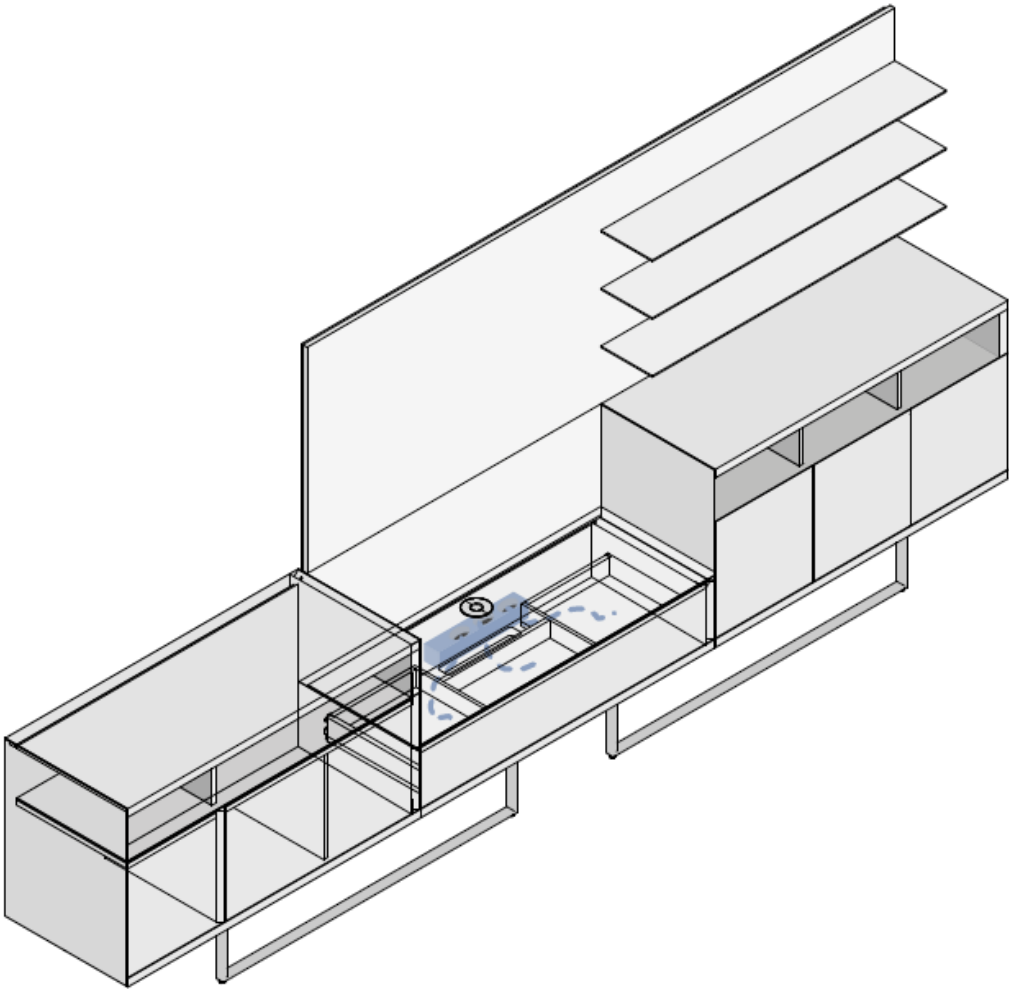

DIMENSIONS

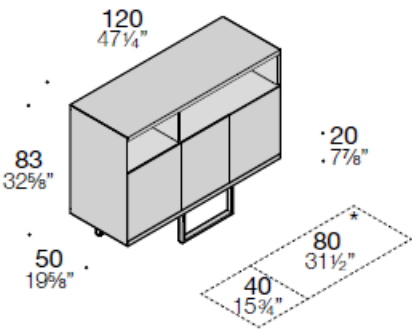

Sideboard W120 (47"1/4) with hinged doors

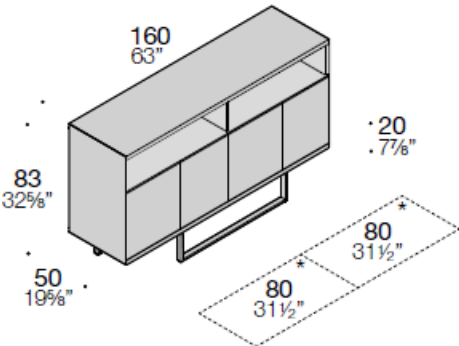

Sideboard W160 (63") with hinged doors

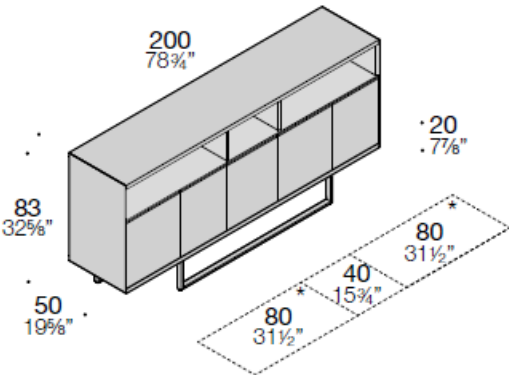

Sideboard W200 (78"3/4) with hinged doors

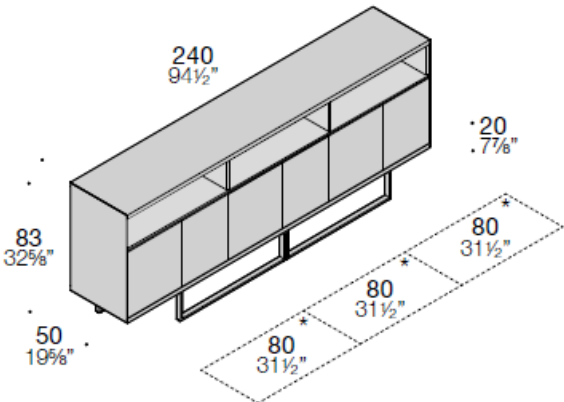

Sideboard W240 (94"1/2) with hinged doors

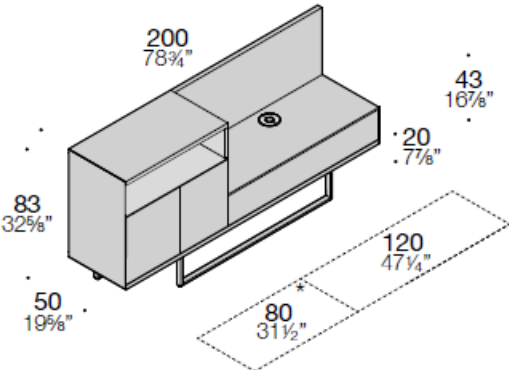

Sideboard W200 (78"3/4) with hinged doors and TV stand with front flap

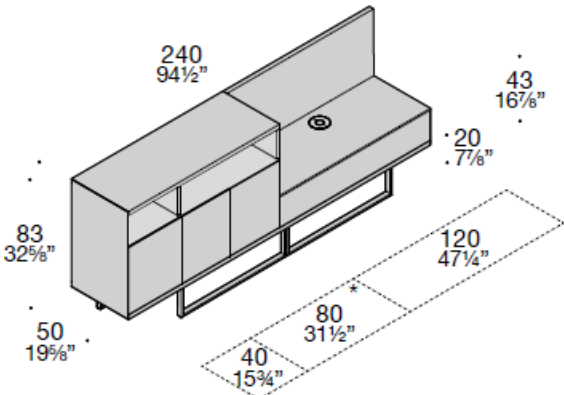

Sideboard W240 (94"1/4) with hinged doors and TV stand with front flap

DIMENSIONS

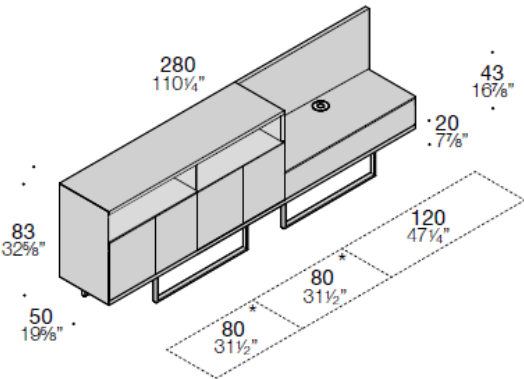

Sideboard W280 (110"1/4) with hinged doors and TV stand with front flap

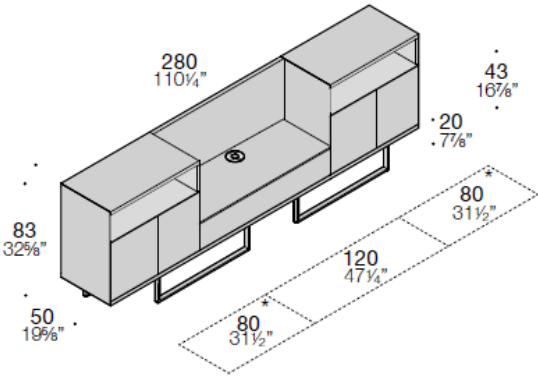

Sideboard W280 (110"1/4) with hinged doors and TV stand with front flap

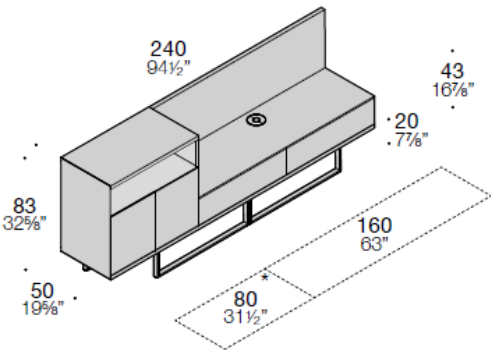

Sideboard W240 (94"1/2) with hinged doors and TV stand with front flap

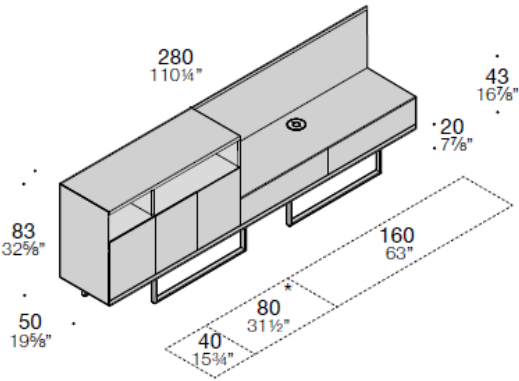

Sideboard W280 (110"1/4) with hinged doors and TV stand with front flap

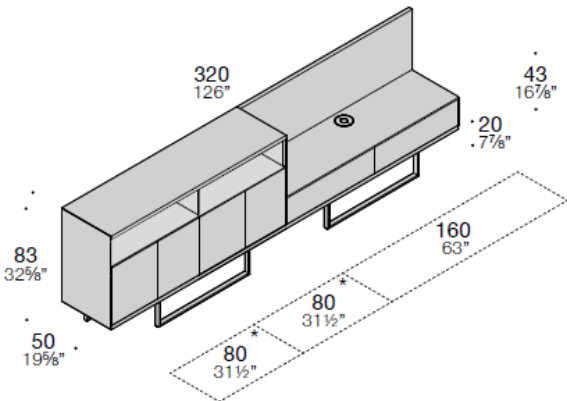

Sideboard W320 (126") with hinged doors and TV stand with front flap

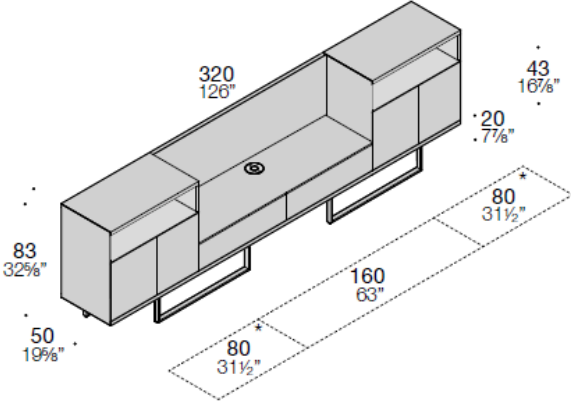

Sideboard W320 (126") with hinged doors and TV stand with front flap

DIMENSIONS

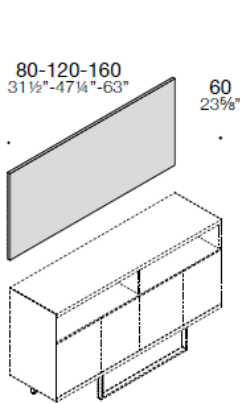

Panels H60 (23"5/8) for wall covering

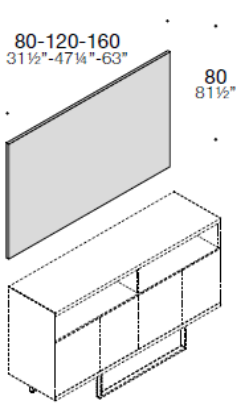

Panels H80 (31"1/2) for wall covering

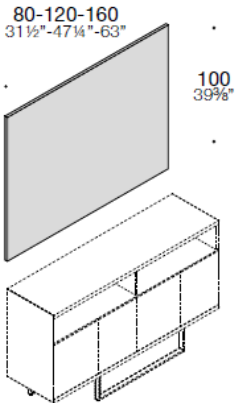

Panels H100 (39"3/8) for wall covering

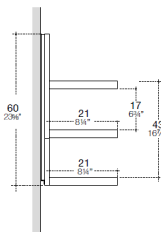
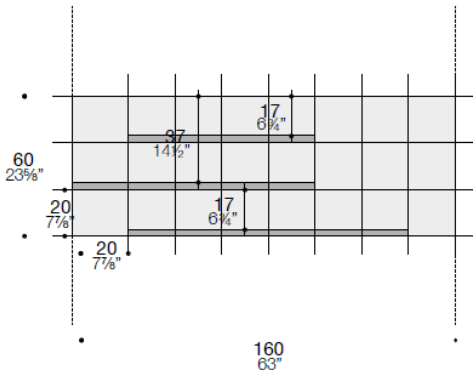

The shelves can be positioned on the panels of the wall covering, at a pitch of 20 cm (7"7/8) in height starting from the lower edge of the panel, at a pitch of 20 cm (7"7/8) in width. Only in the case of upper panels can a shelf (with the function of "sky") be positioned also in the upper edge of the panel.

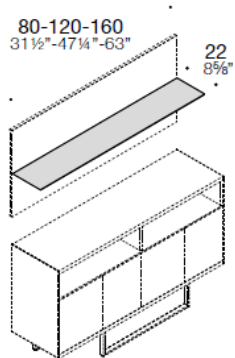

Shelf for wall covering

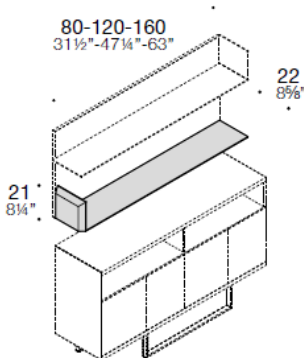

L-shaped shelf

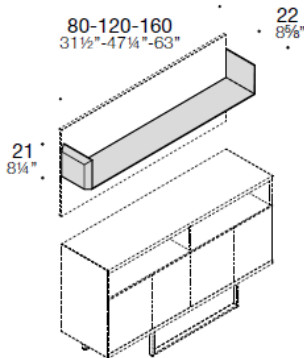

U-shaped shelf

COMPOSITIONS

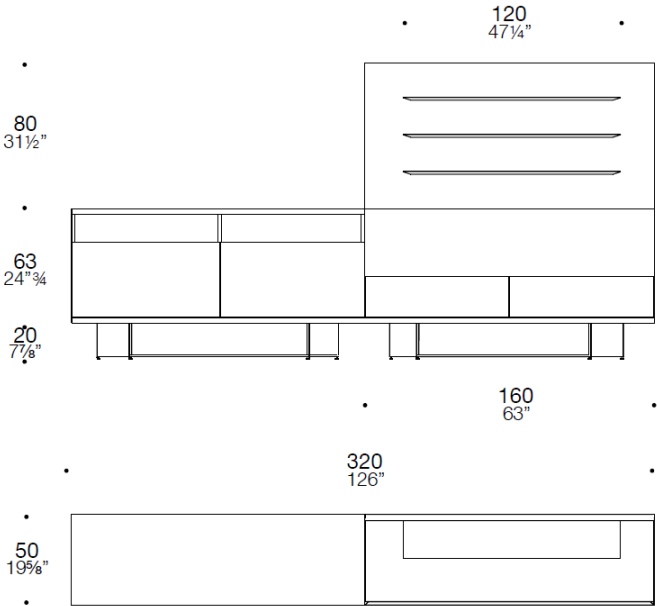
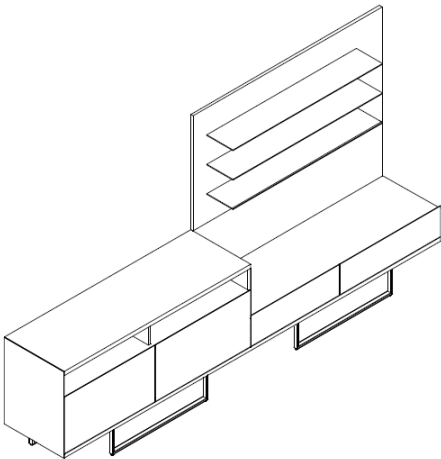

Composition 1

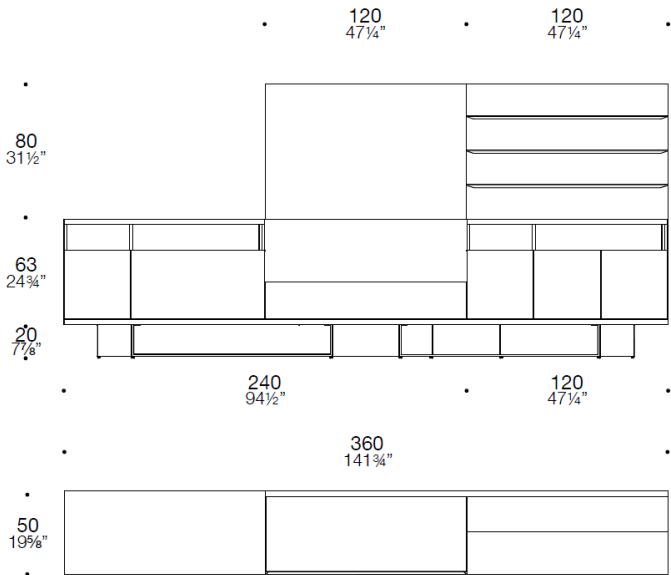
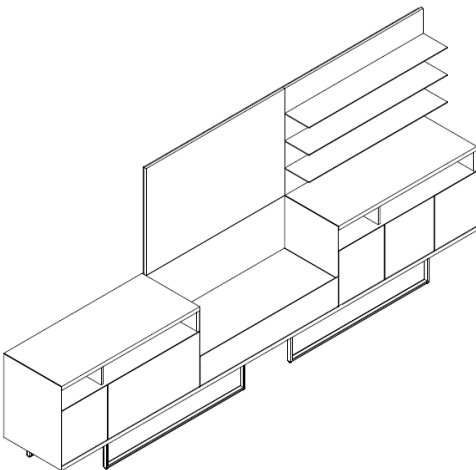

Composition 2

COMPOSITIONS

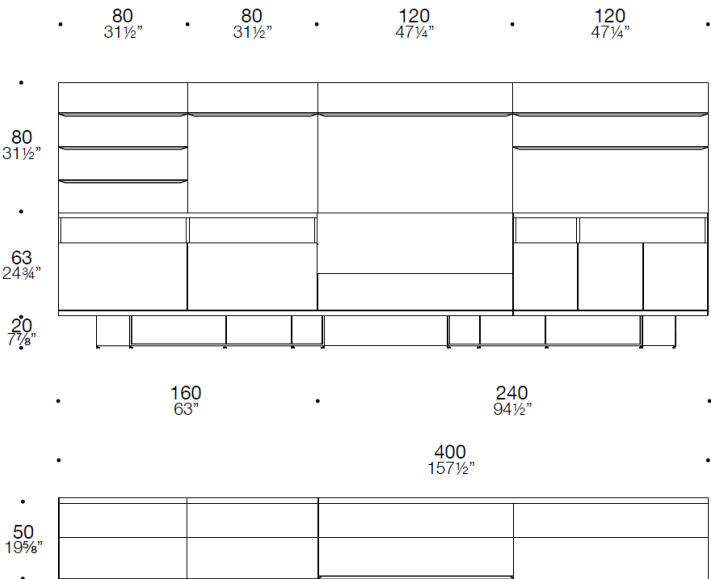
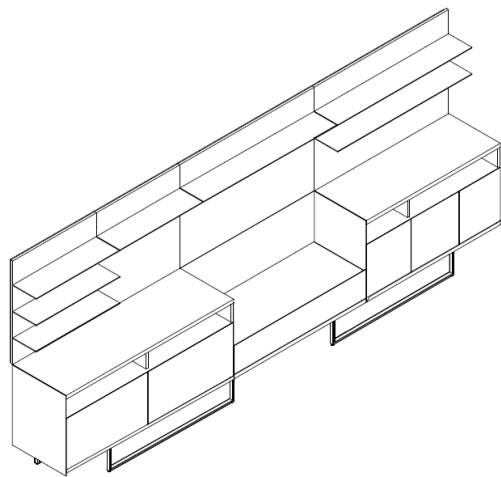

Composition 3



W240 (94"1/2) sideboard composition with hinged doors and TV stand and W120 (47"1/4) sideboard with hinged doors.



HEADQUARTER

Estel Group srl
Via Santa Rosa 70
36016 Thiene (VI) – Italy
Tel. +39 0445 389611
Fax +39 0445 808801
www.estel.com

The information shown is based on the latest published price lists. Estel reserves the right to make any necessary changes to the products shown at any time without notice.

ESTEL rev. 03_11/2019
